

# Fairfield

## V220 EXPOSED 3/4"

### THERMOSTATIC SHOWER

#### INSTALLATION INSTRUCTIONS

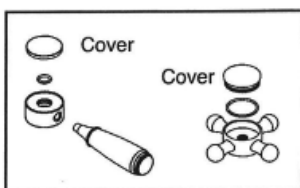
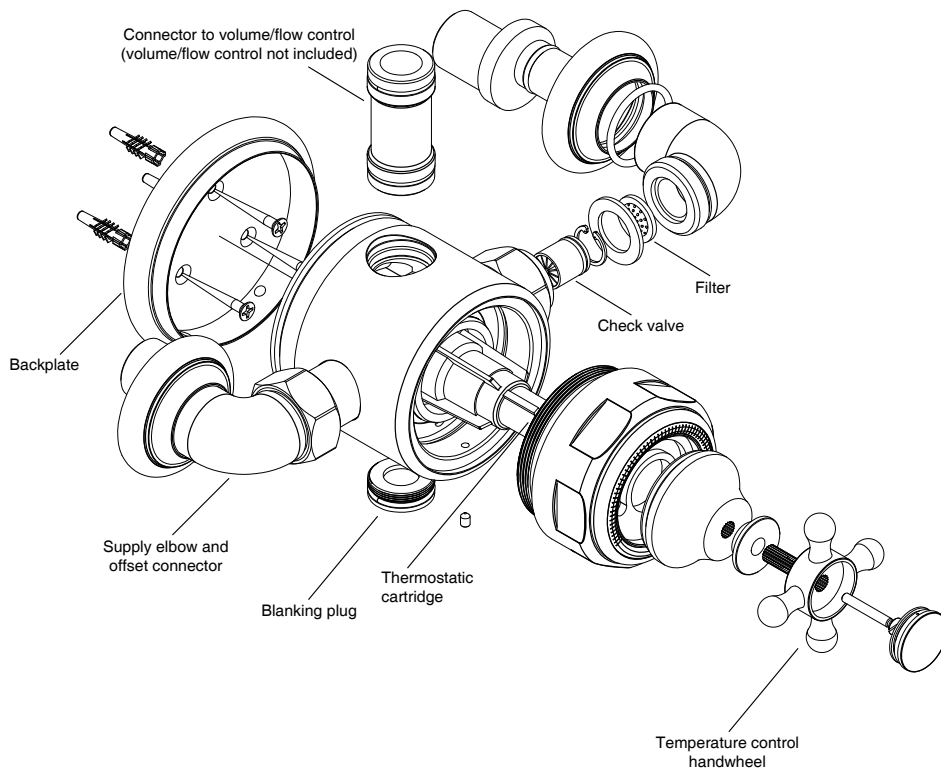

Choice of Lever / Crosstop

ITEM	DESCRIPTION	PART NO.
1	Thermostatic cartridge	VS56063
2	Filter x 2	8-56062

Use the backplate as a template to mark off the fixing holes.

Drill holes then wall plug and screw backplate accordingly.

Fit valve to backplate by securing grub screws and then supplies (hot on left, cold on right).

**Note:** Both hot and cold supplies **must** be flushed thoroughly before installation. When facing the front of the valve the hot connection is made to the left and the cold to the right.

#### IMPORTANT NOTES

1, Installation should be carried out by a competent engineer, in accordance with water regulations.

2, Before installation, ensure supply pipes are flushed clean. Debris or loose particles will affect the efficiency of the ceramic disc cartridge.

3, For mixer faucets, it is recommended that hot & cold pressures are equally balanced.

4, To help maintain the high quality finish, please clean with a soft damp cloth. Do not use abrasive polish or cleaners. Stains may be removed using undiluted washing up liquid.

5, Ceramic cartridges in hard water areas. To prolong the lifespan and reduce servicing periods of your Samuel Heath faucet we recommend that a suitable water softener be fitted. Consult your installer/designer for details.

Remove the valve body from its back plate by releasing the grub screw.  
Set the valve body back plate at the required height then mark and drill screw holes and fix the back plate.

Fit both supply elbows to the valve then offer the valve to the back plate to allow you to mark off the supply lines.

Fit the riser extension to the valve body, ensuring the 'o' ring is well lubricated (spares included).

Torque into place using a 5/8" hex key. Fit the volume control including its back plate to the riser extension.

With the valve body fitted to its back plate, mark around the volume control back plate (thus achieving a template) then remove the valve body, direct coupler and volume control complete.

Remove the volume control back plate by releasing the grub screw and place the volume control back plate to your template then mark off and drill the back plate fixing holes before fitting the back plate to the wall.

Secure both the valve body and the volume control to their back plates by tightening the grub screws. Then tighten all supply connections.

Fit riser to volume control body marking off, drilling and fixing riser bracket at the desired height.

The temperature of the valve is factory set at approximately 43°C. To fitting the lever or cross top control to the unit simply locate the central screw through the lever or cross top into the spline adaptor and ease onto the spline and replace the cover.

### Additional information

This thermostatic valve is suitable for use with all water systems up to a maximum operating pressure of 5.0 Bar, (beyond which we recommend pressure reducing valves be fitted).

The valve has check valves fitted on both hot and cold inlets within the valve. Filters are fitted within both supply elbows.

### Product/System Compatibility

This area should be addressed by the installer or arrangement designer pre-installation.

### IMPORTANT

It is essential that both hot and cold supply lines are thoroughly flushed before installation.

In hard water areas it is recommended that a suitable water filtration unit be fitted.

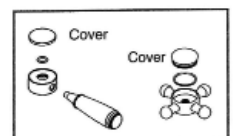
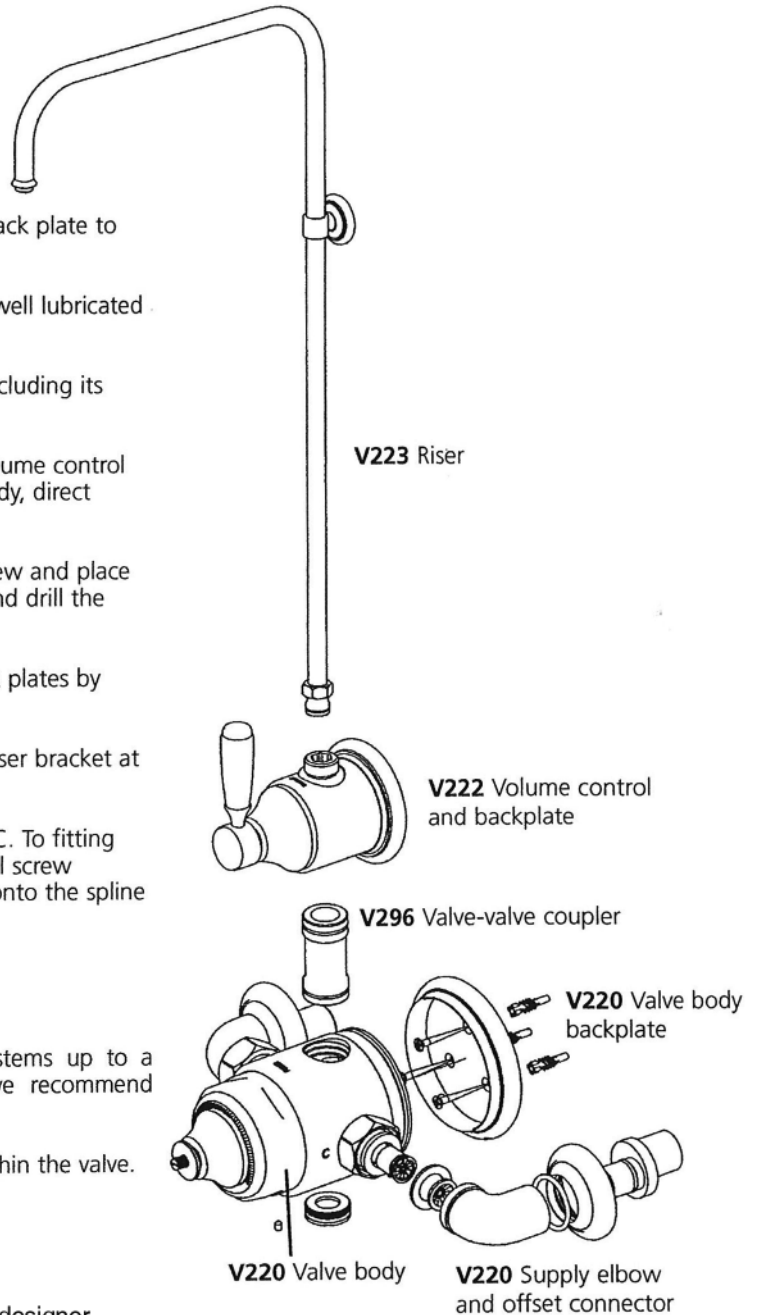

**SAMUEL HEATH**  
for a life less ordinary

samuel-heath.com

ISSUE QWB1 H